

CONNECTOR

Cable Gland

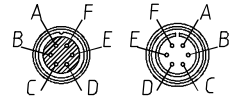

PIN ASSIGNMENT



Receptacle Plug

2-WIRE 4-20mA		3-WIRE Voltage OUTPUT	
A	Red POWER(+)	A	Red POWER(+)
B	White POWER(-)	B	Black COMMON(-)
C	White POWER(-)	C	White SIG(+)
D	(NC)	D	(NC)
E	(NC)	E	(NC)
F	(NC)	F	(NC)
CASE	(NC)	CASE	(NC)

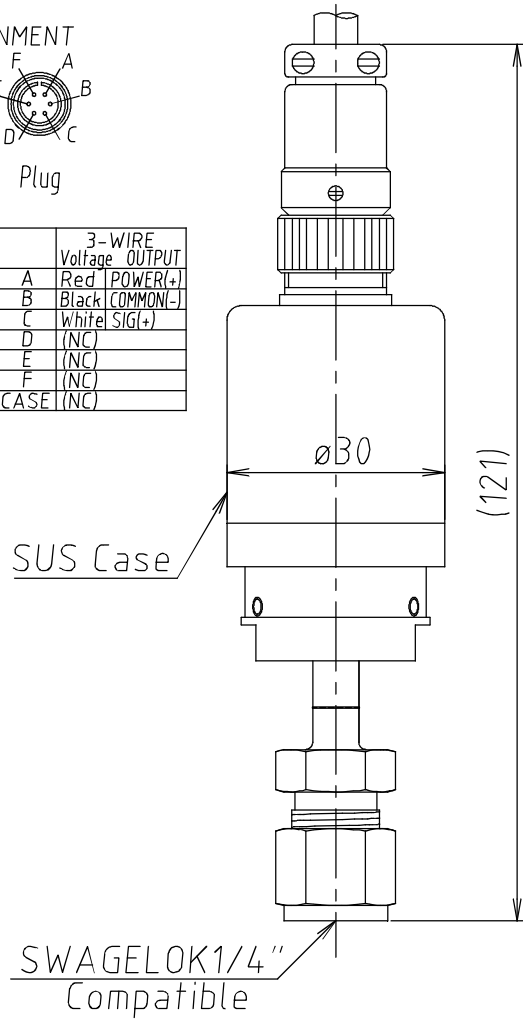

WIRING

OUTPUT SIGNAL:4-20mA

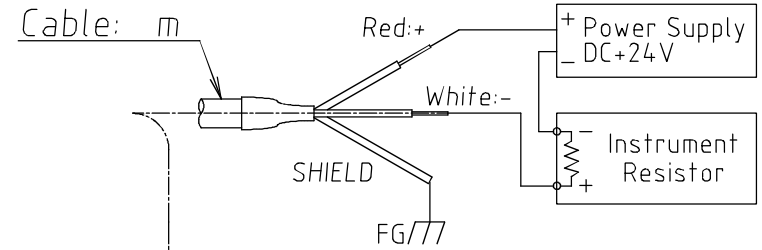

OUTPUT SIGNAL:Voltage Type 3-WIRE

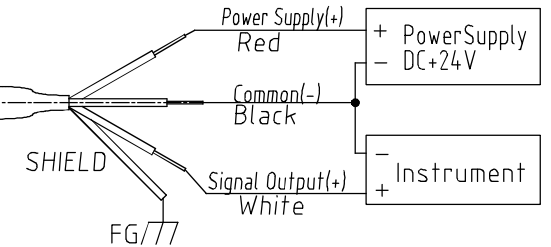

SE700SZS-□□□□C1

Output signal	CONNECTOR
<input type="checkbox"/> 420 :4-20mA	<input type="checkbox"/> T:TAJIMI
<input type="checkbox"/> 005 :0-5V	<input type="checkbox"/> CONNECTOR
<input type="checkbox"/> 105 :1-5V	<input type="checkbox"/> P:Cable Gland
<input type="checkbox"/> 010 :0-10V	

Rev.No.	DATE&NOTE	APP	REV	DSG	APP	TITLE	SCALE	DRAWING No.	Rev.
3						SE700SZS-□□□□C1			1
2							1:1	9901803	
1	2013.8.20 Title change. Pin assignment added.	H.Narita	T.Yamada	K.Yuasa	M.Tsukada	TEM-TECH LAB.	3rd DRAWING	DATE	2007.9.19

CONNECTOR

Cable Gland

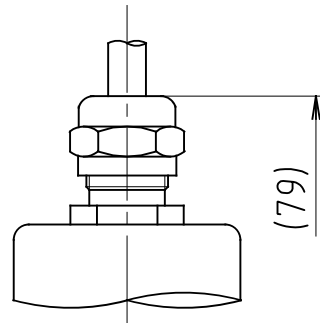
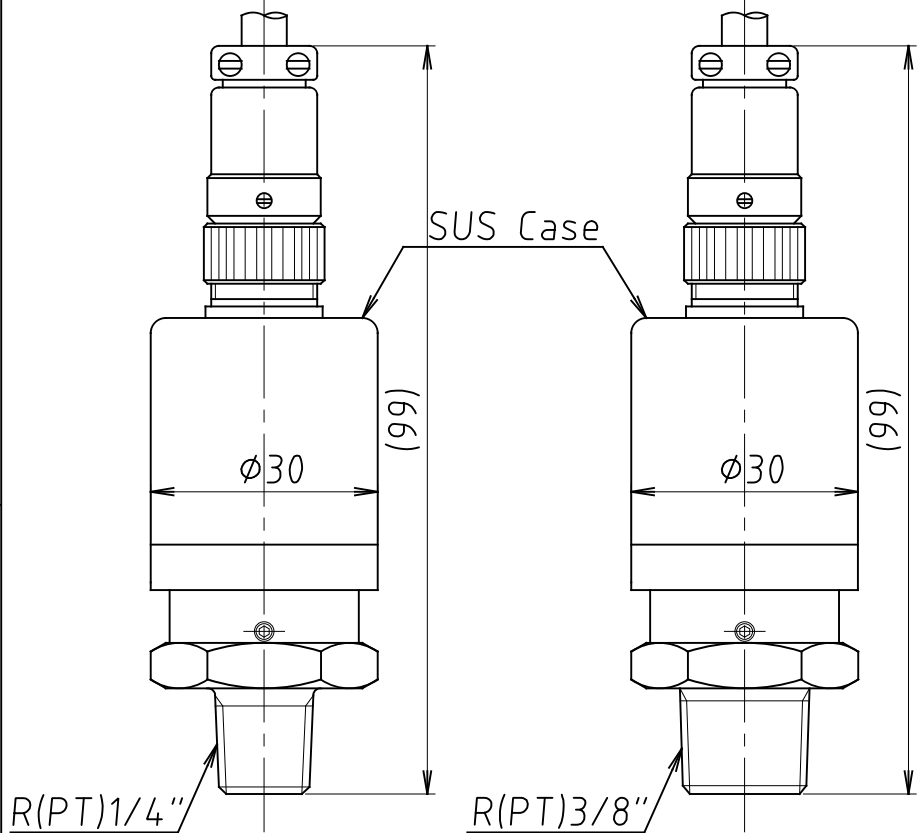

△ PIN ASSIGNMENT

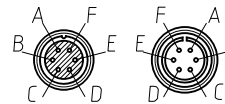

Receptacle

Plug

	2-WIRE 4-20mA
A	Red POWER(+)
B	White POWER(-)
C	White POWER(-)
D	(NC)
E	(NC)
F	(NC)
CASE	(NC)

	3-WIRE Voltage OUTPUT
A	Red POWER(+)
B	Black COMMON(-)
C	White SIG(+)
D	(NC)
E	(NC)
F	(NC)
CASE	(NC)

WIRING

OUTPUT SIGNAL:4-20mA

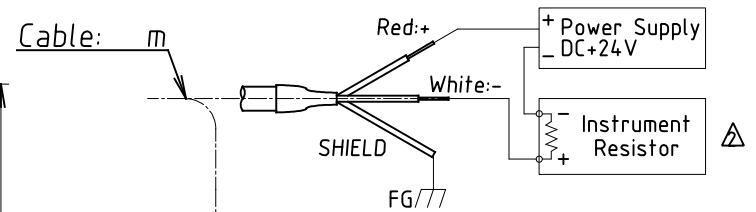

OUTPUT SIGNAL:Voltage Type 3-WIRE

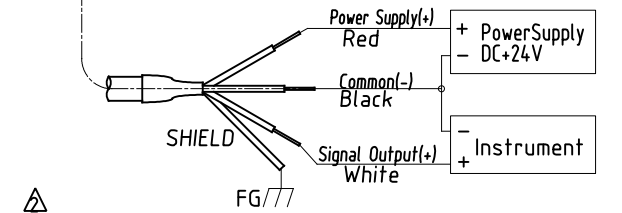

SE700SMR-□□□□□

Output signal
<input type="checkbox"/> 420 :4-20mA
<input type="checkbox"/> 005 :0-5V
<input type="checkbox"/> 105 :1-5V
<input type="checkbox"/> 010 :0-10V

CONNECTOR
<input type="checkbox"/> T:TAJIMI CONNECTOR
<input type="checkbox"/> P:Cable Gland

FITTING
<input type="checkbox"/> 1 :R(P.T)1/4"
<input type="checkbox"/> 2 :R(P.T)3/8"

3 Rev.No.	2015.3.18 DATE&NOTE Fixed a typo. 050→005	APP H.Narita	REV T.Yamada	DSG K.Yuasa	APP	TITLE SE700SMR-□□□□□ (1/4", 3/8"対応) △ <del>SE700H-□□□-SMR□□</del>		
2 Rev.No.	2013.4.10 DATE&NOTE 型番表記修正、コネクタ配線追記	APP H.Narita	REV Y.Kawamura	DSG K.Yuasa	REV	SCALE 1:1	3rd DRAWING	DRAWING No. 9900508
1 Rev.No.	2003.12.04 DATE&NOTE 型番表記、コネクタ形状修正	APP	REV	DSG M.Tsukada	DSG M.Tsukada	TEM-TECH LAB.		DATE 2001.08.16